

Project Title :SITE PLAN FOR LUCC

L.U.C.C. SHOWING THE LAND OF M/S. B.L. BUILDERS, AT 53, RANI SATI MANDIR ROAD, GANGANAGAR, SILIGURI, P.O.- SILIGURI BAZAR, P.S.- SILIGURI, DIST.- DARJEELING, PIN.-734005, WARD NO. 05(SMC)

NOTE: I SHALL MAINTAIN 2.5M AS FRONT OPEN SPACE AT GR. LEVEL. I SHALL NOT CONSTRUCT EVEN STEPS WITH IN THIS FRONT OPEN SPACE.

FLOOR	COMMERCIAL	PARKING AREA	STAIR CASE	RESIDENTIAL AREA	TOTAL	USE
GROUND FLOOR	133.74 M ²	180.67 M ²	20.00 M ²	—	334.41 M ²	PARKING + RETAIL A.C. SHOP
1ST FLOOR	—	—	20.00 M ²	314.41 M ²	334.41 M ²	RESIDENTIAL
2 ND FLOOR	—	—	20.00 M ²	314.41 M ²	334.41 M ²	RESIDENTIAL
3 RD FLOOR	—	—	20.00 M ²	314.41 M ²	334.41 M ²	RESIDENTIAL
TOTAL AREA	133.74 M ²	180.67 M ²	80.00 M ²	943.23 M ²	1337.64 M ²	

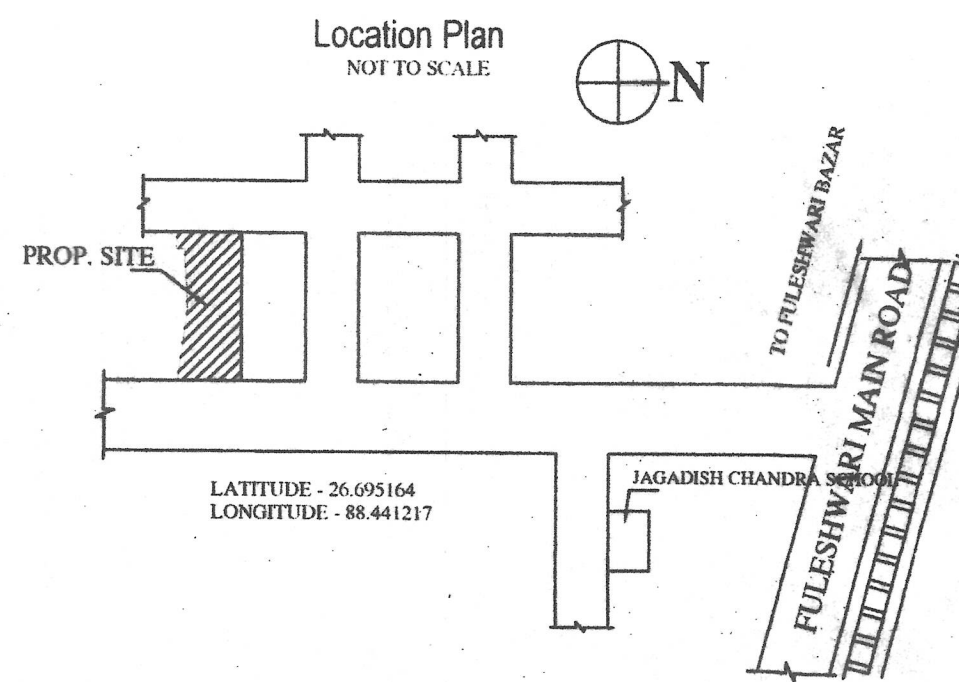
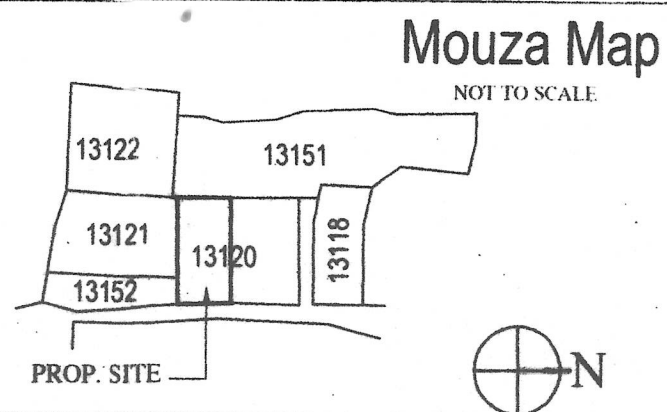

AREA STATEMENT SILIGURI	VERSION NO
JALPAIGURI DEVELOPMENT AUTHORITY	1.0.1
PROJECT DETAIL	VERSION DATE: 30/08/2017
Application No. :-	Plot Use: Residential
Application Type: General Proposal	Plot SubUse: ResiComm Bldg
Project Type: LUCC	Land Use Zone: Residential
Nature of Development: New	Abutting Road Width: 6.7 M
Location: Siliguri Urban Area	Plot No: 12306/13120(RS), 2353 & 2357
SubLocation: Siliguri (M)	Sheet No.: 20
Special Project Type: NA	House No.: -
Ward No: 24	North :-
Name of Street: NA	South :-
Village Name: SILIGURI	East :-
	West :-

AREA DETAILS:		SQ.MT.
AREA OF PLOT (Minimum)	(A)	668.89
NET AREA OF PLOT	(A-Deductions)	668.89
BALANCE AREA OF PLOT	(A-Deductions)	668.89
PLOT AREA FOR COVERAGE	(A-Deductions)	668.89
Plot Area for FAR	(A-Deductions)	668.89
COVERAGE CHECK		
Proposed Coverage Area (49.99 %)		334.41
Proposed Ground Coverage Area (49.99 %)		334.41
Total Prop. Coverage Area (49.99 %)		334.41
FAR CHECK		
BUILT UP AREA CHECK		
Total BuiltUp Area		0.00
ARCH / ENGG / SUPERVISOR (Regd)		OWNER
DEVELOPMENT AUTHORITY		LOCAL BODY

COLOR INDEX
PLOT BOUNDARY
ABUTTING ROAD
PROPOSED WORK (COVERAGE AREA)
EXISTING (To be retained)
EXISTING (To be demolished)

Building / Wing Name	Road Name	Front Margin	Ground Pwork Front Margin	Rear Margin	Ground Pwork Rear Margin	Side1 Margin	Ground Pwork Side1 Margin	Side2 Margin	Ground Pwork Side2 Margin
PROP. BUILDING	6.7 M WIDE S.M.C. ROAD	2.51	2.51	3.29	3.29	1.21	1.21	4.00	4.00

SCHEDULE OF LAND
 MOUZA :- SILIGURI NOW SILIGURI DAKSHIN 2
 JL. NO. :- 110 (88) (RS), 93 (LR)
 PLOT NO. :- 12306 / 13120 (RS), 2353 & 2357 (LR)
 KHATIAN NO. :- 4273/9 & 4273/11(RS), 5969 (LR)
 R.S. SHEET NO. :- 20
 P.O. :- SILIGURI
 P.S. :- SILIGURI
 DIST. :- DARJEELING
 WARD NO. :- 24 (SMC)

AREA STATEMENT
 AS PER DEED = 668.89 SQM.
 AS PER SITE = 668.89 SQM.
 PERMI.GR.COVERAGE = 49.99 % OR 334.41 SQM.
 PROP.GR.COVERAGE = 49.99 % OR 334.41 SQM..
 COMM. AREA GR. GROUND FLOOT = 133.74 SQM.
 TOTAL FLOOR AREA = 1337.64 SQM.
 Achived Ground Floor Area= 334.41 SQM.
 1st, 2nd. & 3rd. Floor Area= 334.41 SQM. (each floor)

PROJECT:-
 FOUR STD.RESI. CUM COMM. BLDG.

B. L. BUILDERS
Rahulrajyamaal
 Partner

SIGNATURE OF OWNER

Arjun Barman
 Arjun Barman
 Licensed Building Surveyor
 SMC Expanded No.- II - 102
 SIDA Licensed No. 0548
 Durbhandy Para, Siliguri-04
 Mob.- 959735547, 9547813250
 Email: arjunbarman28@gmail.com

SIGNATURE OF L.B.S

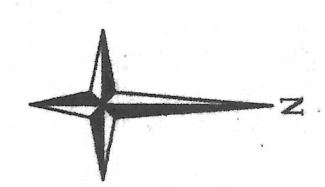
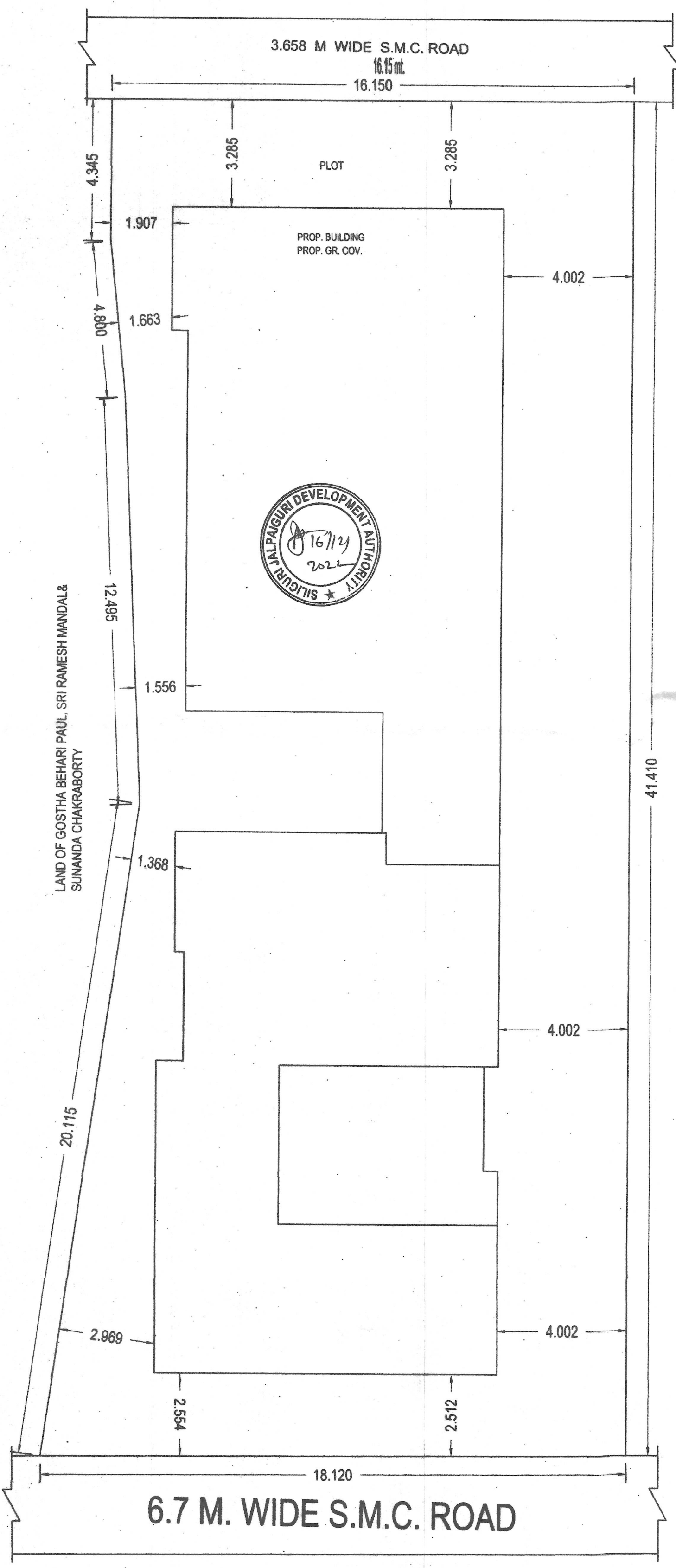

Site Plan
 SCALE-1:1 (FOR DWG FILE)
 Site Plan
 SCALE-1:100 (FOR PRINT FILE)